



## ***garage cabinets***

- Built for the garage environment
- Powder-coated exterior surfaces
- More than 500 cabinet choices
- Multiple color choices
- Made in the U.S.A.



# Organize. Store. Simplify. AND LOOK



## What do you want in your garage?

Room for another car? Places to neatly store things out of sight and within easy reach, but easy to find? A clutter-free floor? A workplace for car care, woodworking or gardening? Space to store out-of-season items? Or just a garage that you're not ashamed for your neighbors to see?

From cabinets that organize and neatly store your stuff, to storage walls that let you clear things off your floor and keep it in easy reach... **garagegear** can help. Whether your garage is large or small, **garagegear** has the solutions for your garage and your needs.

Whatever you want in your garage, start with **garagegear**. With more than 500 cabinet choices in a variety of colors, you can have the garage you have always wanted...clutter free! A usable workbench. Tools and equipment in their places. A floor free of toys and gardening equipment. Last but not least, room for your car. Now you can spend your time doing things... not looking for things.

GREAT!



**THE PROBLEM...** Clutter is everywhere. Tools and equipment get misplaced. Toys and gardening tools cover the floor. Cleaning is almost impossible. And where do you put a second car?



**THE SOLUTION...** Get everything off the floor! **Garagegear** storage solutions are wall-hung, getting you organized and freeing limited floor space for other things...like your car.

## Garagegear makes it easy

No matter what **garagegear** solution you choose, our goal is to make it easy for you. You decide what you want, and we will do the rest.

### Easy to install

RedLine **garagegear** is sold and installed by factory trained and certified agents. We will design a custom solution for you, order the materials and install your new storage system. You can be sure everything will work right...the first time. Nothing for you to do, but put everything in its place, and enjoy your regained space.

### Easy to use

From the start, you will find these cabinets are a pleasure to use. Smooth gliding full-extension drawers and wide opening

cabinets allow you to easily put things away, and find them when you need to. The tough finish and worksurfaces are designed to stand up to day-to-day use, and keep working for years.

### Easy to maintain

A simple damp cloth will wipe away most common dirt. Stubborn grime, such as grease or oil, can be cleaned with most household cleaners. The tough powder-coated finish and work surfaces can withstand almost any cleaner or solvent. Finally, the off-the-floor design makes it easy to clean beneath and around your cabinets.

### Easy to organize

These cabinets are designed to help you organize and keep organized. A

wide variety of drawers, cabinets and tall storage cabinets with customizable interiors make it easy to have the type of storage space you need to fit things. And speciality cabinets for tools and small parts keep everything in its place, easy to find and put away.



We proudly support  
our troops around  
the world.



# The garagegear solution

RedLine **garagegear** cabinets and storage solutions offer the finest garage and workshop organizer systems available. From their wall-hung design to their attractive and extremely durable finish, these storage cabinets set the standard. Unlike big-box store solutions, RedLine **garagegear** is built to last. In fact, our RedLine Storage Cabinets are guaranteed for a lifetime\*.

RedLine cabinets are designed to give you years of trouble-free service. We build quality and dependability in before you put anything in them.

## Custom designed and built

**Garagegear** cabinets are designed and built specifically for you, your space and your needs. Upon receipt of your order, we manufacture your cabinets to your exact specifications. No off-the-shelf pre-built solutions and everything is American made.

Whether you need a work surface for a workshop, gardening, hobbies, or just cabinets for storage, we have you covered. And now you can bring the worksurface to your work with our Rolling Workbench.

If your space is limited, we have cabinets that fit in as little as 12" of space and require only 7" of clearance to open.

*\* See Warranty details on the inside back cover of this catalog.*



What separates **garagegear** from its competitors? Here are some of the major reasons **garagegear** is different (and better).

## Tough skinned

They say beauty is only skin deep, but the skin on these cabinets is as tough as it is beautiful. The powder-coated finish seals all exterior surfaces – no seams or cracks – and creates a hard durable surface that will withstand cold, heat, humidity, oil, grease, household chemicals, dirt and grime, all found in the garage. And the finishes are as attractive as they are durable, with many exciting decorator colors from which to choose.



## Off-the-floor design

RedLine cabinets hang on the wall to eliminate two of the biggest problems with freestanding units; moisture on the floor, and uneven floors. Unlike other systems, our hang rails are 2" wide for greater strength and stability, while at the same time creating a natural pathway for wiring.

## Quality throughout

All drawers are constructed from 9-ply Baltic birch plywood, and feature time-tested dovetail construction for long-life durability. Full-extension drawer slides feature precision ball-bearings for a maintenance-free life, and are rated at a capacity of 100 pounds.

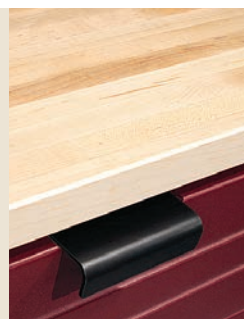

### Engineered for everyday use

First and foremost, **garagegear** has been designed for the user. Wide-opening cabinets and full-extension drawers make access easy. Durable powder coated finishes and tough work surfaces need little or no maintenance. Quality materials and hardware throughout ensure a long trouble-free life. These are cabinets you can count on today and for many years to come.

### Built for durability

We built our cabinets to withstand the extremes of temperature and humidity found in the typical garage and still function efficiently. Cabinet exteriors are powder-coated for an attractive, durable finish that outperforms paint or laminate finishes. Work surfaces will stand up to heavy every day use and still look great. Drawer boxes feature superior Baltic birch, dovetail construction and full-extension drawer glides with precision ball bearings for extended use. And heavy duty hardware throughout will last the lifetime of the cabinets.

### Personalized storage and workspaces

Whatever your needs and lifestyle—gardening, woodworking, auto shop, sports, or just plain storage—we will custom design a solution just for you. These are cabinets you'll enjoy using every day for a lifetime!

### Industry-leading flexibility

Other companies may give you several cabinet choices in a single depth...we give you more than 500 and in multiple depths. With a choice of colors, styles and sizes we can create a solution to fit virtually any space and need.

### Professional installation

**Garagegear** is installed by certified professionals. You choose the solution, we do the work.

### Industry-leading warranties

All our cabinets carry a Lifetime Warranty\*, ensuring years of dependable service. You won't find warranties like these on any competitive products.

*\* See Warranty details - inside back cover*

### Easy-to-use design

**edLine** cabinets were designed from the start to be functional and user-friendly. Wide opening doors and full-extension drawers ensure easy access. Shelves can be adjusted to suit individual needs. All surfaces can be easily cleaned. These cabinets will be a pleasure to use for years to come.

### Work surfaces that can take a beating

Our black urethane work surfaces are coated with the same material used on truck beds, creating a water-tight, chemical-resistant finish.

Butcher block tops are constructed of 1-1/4" hardwood maple with a clear protective coating. This beautiful wood will withstand heavy use for years to come.



# Garagegear Cabinets and Accessories

Garagegear cabinets were designed and built specifically for the typical garage environment:

- Powder-coated exterior surfaces, with multiple color choices
- More than 500 cabinets choices
- 9-ply Baltic birch plywood drawers – won't warp or disintegrate
- Drawers feature dovetail construction for strength
- Full-extension drawer slides with 100 lb. static and dynamic rating
- 6-way adjustable door hinges
- Anodized aluminum or stainless steel handles – resist rust and corrosion
- Powder-coated steel hang rail
- Cabinets depths of 12", 16" or 24"
- Single and bi-fold doors available for tight spaces and limited clearance
- Lifetime Warranty - details on page 11

## Cabinet Finishes

Garagegear cabinets feature powder-coated finishes in more color choices than any other manufacturer. Powder-coated MDF outperforms plastic, paint or laminate, and resists chipping, denting, peeling or warping.

All exterior doors and panels are MDF. Each piece is sprayed with a powdered mixture and heated, causing the powder to gel and flow, bonding to the MDF and completely sealing the piece. The resulting finish is attractive and durable. The process is environmentally friendly... no heavy metals, solvents or VOCs.



**Upper Cabinets**  
Double and single door units – with adjustable shelf, in two heights.



**Lower Cabinet**  
Single and double door designs, with or without drawer.



**Trash Pullout**  
Full extension drawer holds 13 qt. trash can.



**Storage Cabinet**  
Adjustable shelves with optional pullout shelf. 5 shelves standard.



**Bi-fold Doors**  
Bi-fold doors require only 7" to open. Great for limited space.



**Lockers**  
Great storage spaces for individual family members.

## Powder-coated Finishes



**Platinum**  
Stippled matte finish

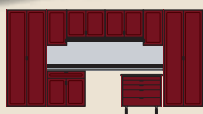

**New Burgundy**  
Hammertone finish



**Sandstone**  
Light textured semi-gloss



**Earthstone**  
Light textured semi-gloss



**Mid-life Crisis Orange**  
Hammertone



**Pewter**  
Hammertone finish



**Storage Bin Pullout**  
Equal sided with 32 removable plastic bins.



**Drawer Cabinet**  
Full extension drawers with 50 lb. capacity each. 3 to 7 drawer units.



**Workbench**  
Available in multiple sizes and configurations, with legs or casters. See page 9 for details.



**Work Surfaces**  
Beautiful and durable Maple Butcher Block or industrial-strength black Impact Coating.







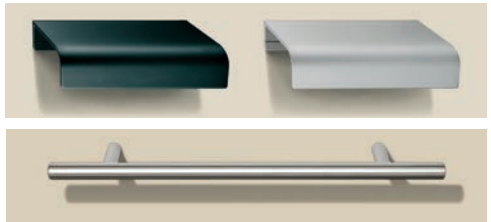

**Corner Cabinet**  
Wrap your cabinets around the corner. All, upper and lower cabinets.



**Garage Closet**  
64" wide open unit with folding doors. Great for storing tall or large items. Shown with optional slatwall.



**Door Handles**  
10" stainless steel, bar-style handles or anodized aluminum in black or satin nickel finishes.

					
<b>Royal Blue</b> Hammertone finish	<b>Yellow</b> Hammertone finish	<b>Red</b> Hammertone finish	<b>Silver Vein</b> Hammertone finish	<b>White</b> Stippled matte finish	<b>Black</b> Hammertone finish

*Actual colors may vary from those shown here. Colors are subject to change. See your Agent for current samples.*



# Custom Workbenches

Custom Workbenches share all the same features as our **garagegear** cabinets, but are freestanding, so they can be located anywhere, even the middle of your garage if you choose. Workbenches are mounted on adjustable legs, or casters, and feature finished powder-coated back panels so they look great on all sides.

Workbenches are a great complement to our wall-hung cabinets. They use the same lower cabinet drawer units, door units, bins and tops as our regular cabinets (see the Cabinet Choices page to the right). Mix and match these components to create the Workbench for you.

## Stationary Workbench

The Stationary Workbench is a free-standing unit with adjustable legs, available in 16", 32", 48", 64" or 80" widths, with a 24" deep worksurface. In addition, the 80" unit can contain a knee hole for sitting. The larger units feature additional legs for stability.

## Rolling Workbench

Move your work surface, tools and equipment to your projects, with our Rolling Workbench. Large 6" rubber casters roll easily and quietly wherever you want and lock for stationary use. Available in 16", 32", 48", 64" or 80" widths.



*Rolling Workbench features smooth rolling locking casters*



*80" cabinet is available in rolling (above) or freestanding styles*



*Knee hole is available only on the stationary 80" Workbench*

### STATIONARY WORKBENCH

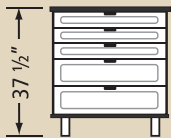

16" or 32" Workbench  
Drawer or door units  
24" depth



48" or 64" Workbench  
Mix drawer and door units  
24" depth

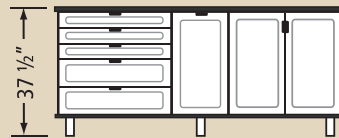

80" Workbench  
Mix drawer and door units  
24" depth



80" Workbench  
Drawer and door units with knee hole  
24" depth

### ROLLING WORKBENCH

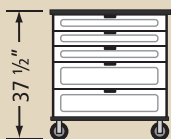

16" or 32" Rolling  
Drawer or door units  
24" depth



48" or 64" Rolling Workbench  
Mix drawer and door units  
24" depth

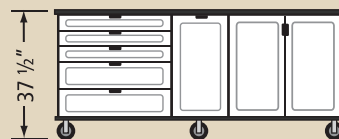

80" Rolling Workbench  
Mix drawer and door units  
24" depth





# Cabinet Choices



Garagegear offers more cabinet styles and sizes than any other garage cabinet manufacturer. With more than 500 cabinet variations and multiple colors from which to choose, you can find a perfect fit for your space.

## UPPERS

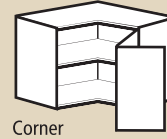
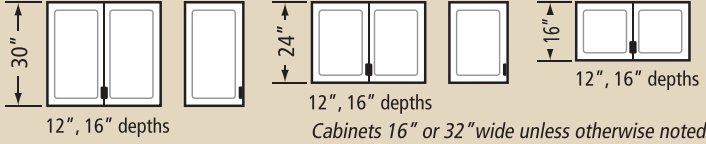

**OVER 25 CHOICES**

## LOWER CABINETS

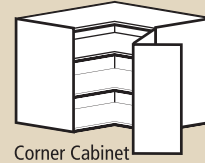
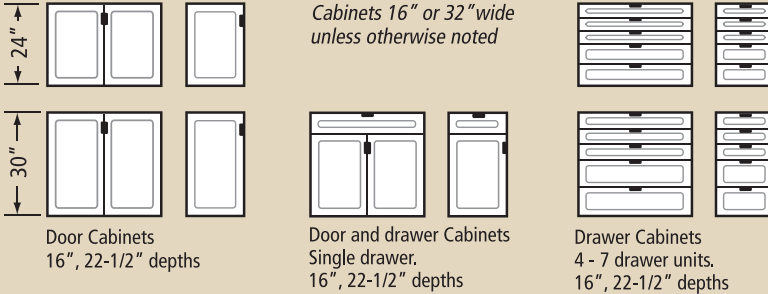

**OVER 50 CHOICES**

## TALL STORAGE CABINETS

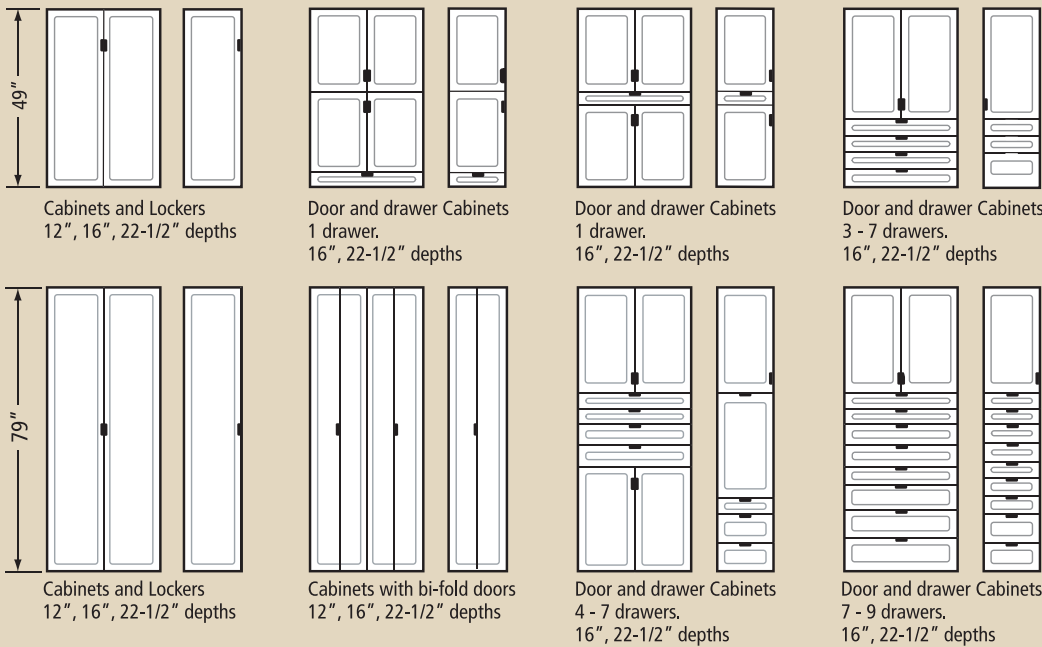

Cabinets 16" or 32" wide unless otherwise noted

**OVER 250 CHOICES**

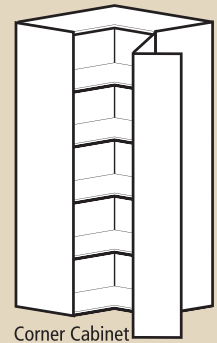

## SPECIALITY CABINETS

**OVER 75 CHOICES**

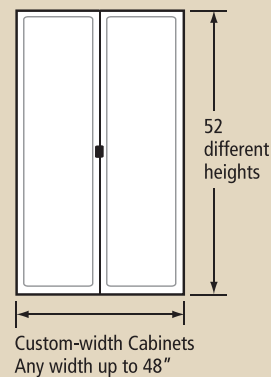
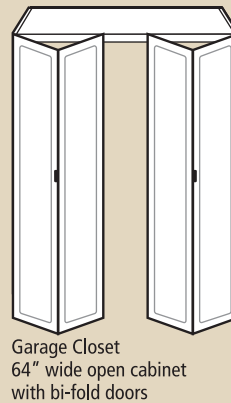
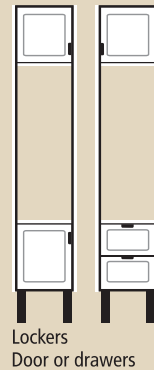
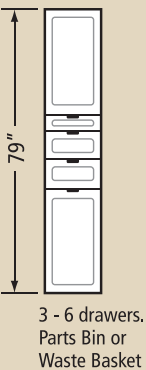

Cabinets 16" or 32" wide unless otherwise noted

# Additional Storage Options

## HandiWALL®

HandiWALL® slatwall is the perfect companion for **garagegear** cabinets. Get everything from bikes to toys to garden equipment off your floor and keep them visible and in easy reach.

HandiWALL features heavy-duty interlocking panels of industrial-grade thermoplastic that are waterproof, mold and mildew resistant. Available in eight colors, HandiWALL will blend beautifully with your **garagegear** cabinets.

A large variety of accessories from hooks to shelves to bins are available. Just snap them into place and you're finished. And rearranging things couldn't be much easier. Simply move your hooks and bins to different locations on your HandiWALL, and you're done.



Available in eight colors to blend with **garagegear** cabinets.



A huge assortment of hooks, pegs, shelves and baskets



Great for keeping hand tools in easy reach.



Perfect for gardening tools and supplies. Lots of hooks, bins and shelves to choose from, as well as speciality holders.



## Overhead Storage Racks

Still need more storage space? Use the space over your head. Our ceiling storage racks are an economical way to add overhead storage. Ideal for bulky items, boxes or storage containers and out-of-season items.

Constructed of steel with a durable white finish, overhead racks feature adjustable heights to fit your space. Units are available in 4' x 4' or 4' x 8' sizes. Multiple units can be used together to increase your space as needed.



Keep sports equipment and toys off the floor, but still within easy reach when the mood strikes.



Horizontal rack for bikes and equipment



Hose holder with storage compartment



Double bin recycling center with lids

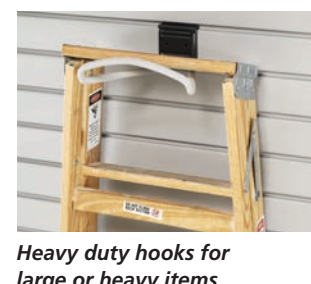

Heavy duty hooks for large or heavy items



Ceiling Storage Rack



A line of heavy-duty accessories is available to fill any storage need you may have.



# Getting Started

Our process is simple...at least for our customers. The entire process has been designed to minimize your effort while keeping you in control. It all starts by contacting an Authorized Agent.

## Contact your local Agent

If you have a printed copy of this brochure, chances are you know your local Agent. If you don't, visit us at [www.redlinegaragegear.com](http://www.redlinegaragegear.com). Click on "Find an Agent" on the top of the Home page. You'll be asked for your ZIP code so we can find an Agent in your area. You'll be forwarded to your local Agent's web page, where you'll find contact information. Simply call or email.

## Consultation

Once you have contacted your Agent, he or she will set up an appointment to discuss your needs and budget, and to get specific information on the space you need organized. This initial consultation takes about an hour or so, depending on your project, and your goals.

## Design and Proposal

Based on the information you provide, a design will be created specifically for your requirements. All designs are custom,

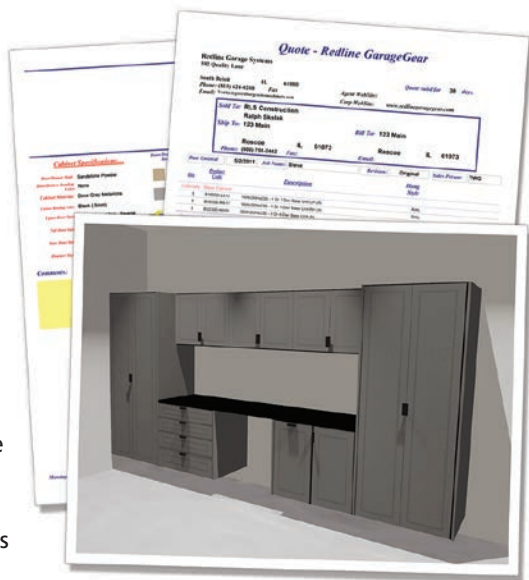

since no two garages or needs are the same. In a couple of days you'll receive a detailed written quote and a 3-D drawing of the proposed design. Once you've settled on a design, our work begins.

## Manufacturing

Designs and specifications are sent directly to our factory, where your garage cabinets will be custom manufactured. Our facilities are state-of-the-art, ensuring your finished cabinets meet our exacting quality standards. In a week or so, your product will ship directly to your home for installation.

## Installation

Final installation usually takes only a day or two depending on the size of your project. Now it's up to you to fill your new cabinets and enjoy your new organized space.

## About RedLine Agents

RedLine **garagegear** is sold and installed only by Authorized Agents. Our Agents are factory trained and certified in the proper handling and installation of all **garagegear** products. You can be sure everything will work properly and stay that way.

Agents are assigned regional territories, so you will always be dealing with the same people. They'll want you to be satisfied, and so do we!



## Need more help getting organized?

Has clutter taken over your garage? "The Book on Garage Organization" will take you through a step-by-step process to banish clutter and keep it from coming back. Buy it in hard-cover or ebook format on [amazon.com](http://amazon.com) or get a pdf for free on <http://www.redlinegaragegear.com>



Either way, you'll get your clutter under control for good!

## Garagegear Warranty

RedLine Cabinets with a powder-coated finish are guaranteed to function normally for a lifetime when installed by an Authorized RedLine Agent. Covered items include cabinet doors, work surfaces, pulls, hinges, castors and glides.

To qualify, cabinets must be the original, unmodified installation and in the possession of the original owner.

Minor scratches, dents, nicks, and scuffs are normal wear and are not covered. Deliberate or excessive abuse is not covered.

See your Authorized Agent for complete warranty details.

